

B8 . B2. TP. PROBES

B8 BUND Switch:

Float lifts in liquids from

0.7 to 1.5 SG

Circuit opens when the float lifts in liquid.



B2 WATER Switch:

Float sinks in less product.

Float lifts in water and opens the circuit



Switch: than 0.9 sg

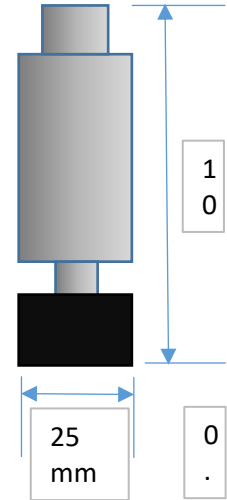

B2-T

B2T Combines Water sensor & Temperature

TP Temperature

Probe:

10K3A1B Thermistor

0-70 degrees C Range



Features:

Standard sensors come with 6 meters of Black PVC sheathed cable. + 1" Fitting.

Float Down = Contact closed = Standard

Reverse Float for Normally Open when down, and close when rise

IP68 submersible Enclosure.

B2-ATEX and B8-ATEX Available

REED Switch in B2 and B8:

Contact rating is 10 Watts

Switching voltage 200 VAC/VDC

Switching current 0.5 A



Typical Applications

GASOIL , DIESEL, KEROSENE, ADBLUE LUBE OIL, COOKING OIL, GEAR OIL

WATER, ANTI-FREEZE, WINDSCREEN WASH